

**De Dietrich** 

INSTRUCTIONS FOR USE  
**DISHWASHER**





*Dear Customer,*

*You have just acquired a **DE DIETRICH** dishwasher and we would like to thank you.*

*Our research teams have created this new generation of appliances for you. Their quality, design, features and technological advances make them exceptional products, and reveal our unique know-how.*

*Your new **DE DIETRICH** dishwasher will blend harmoniously into your kitchen and will perfectly combine washing and drying performance and ease of use. We wanted to offer you a product of excellence.*

*In the **DE DIETRICH** product range, you will also find a wide choice of hobs, ovens, microwaves, hoods, cookers, fridges and freezers that you can coordinate with your new **DE DIETRICH** dishwasher.*

*Visit our website , [www.dedietrich-electromenager.com](http://www.dedietrich-electromenager.com) where you will find our latest innovations as well as useful and complementary information.*

**DE DIETRICH**  
**Setting New Values**

*As part of our commitment to constantly improving our products, we reserve the right to make changes to them based on technical advances to their technical and functional features and appearance.*

**⚠ Warning : Before installing and using your appliance, please carefully read this Guide to Installation and Use, which will allow you to quickly familiarise yourself with its operation.**

[www.dedietrich-electromenager.com](http://www.dedietrich-electromenager.com)



Dear customer,





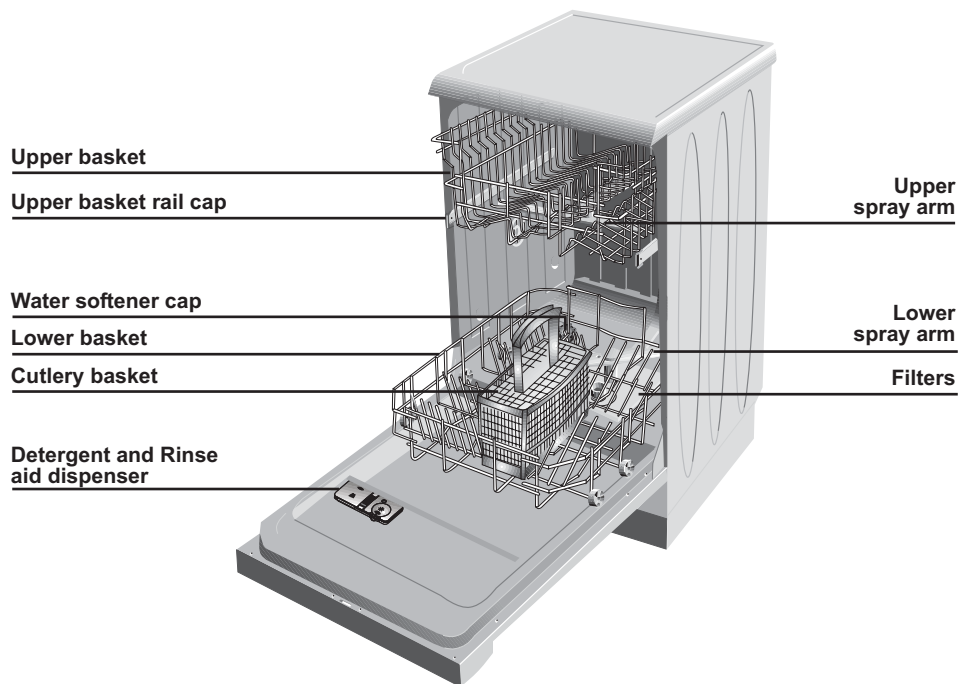



Please read these instructions before installing the dishwasher and using it for the first time. The information contained herein is provided to avoid accident risks and/or damage to your appliance

Please keep these instructions in a safe place for your future reference



---

## TABLE OF CONTENTS

	<b>1. Section</b>	Warning and safety information	3
		Electrical safety	3
		Children's safety	3
		General	4
		Environmental care	5
		Unsuitable dishware	5
	<b>2. Section</b>	Before first use	6
	<b>3. Section</b>	Connections	6
		Electricity connection	6
		Water connection	7
	<b>4. Section</b>	Usage Information	8
		Water Softener	8
		Detergent	10
		Rinse - Aid	11
	<b>5. Section</b>	Loading the Dishwasher	13
		Unloading the dishwasher	13
	<b>6. Section</b>	How to clean your machine	14
		How to clean the filters	14
		How to clean the spray arms	15
	<b>7. Section</b>	How to change the place of your dishwasher	15
	<b>8. Section</b>	Troubleshooting	16
	<b>9. Section</b>	Standard and testing information	16



## Warnings and Safety Information

### Electrical safety

The dishwasher should be operated under the operating voltage specified. For electrical safety, only earthed plugs and plug sockets should be used. Always use the fused plug provided with the appliance. The user is responsible for meeting these basic safety requirements. The life of your machine and your safety depend on your using an electrical installation compliant to standards.

Do not use an extension cable.

When disconnecting your machine from the mains supply, always pull from the plug. Never pull the cord itself.

### Child safety

Never allow you children play with your dishwasher.

Dishwasher detergents contain irritants and abrasives. These ingredients might have caustic effects in the eyes, mouth and throat. They can be extremely dangerous if swallowed. avoid contact with skin and eyes. Check that the detergent receptacle is empty after completion of the wash cycle.

Keep detergents out of children's reach and do not put detergent in the machine until right before you start the washing program.

The water in your dishwasher is not suitable for drinking, for this reason do not allow your children near your machine when the front door is open.

Never allow your children play on or sit onto the front door when the front door is open.

After unpacking your machine, keep the packing material out of children's reach.

### Warning !

The appliance is not intended for use by young children or infirm persons without supervision.



## Warnings and Safety Information

### General

This dishwasher has been designed to clean your dirty dishes at home.

Never use chemical solvents in your machine; this may lead to explosion risk.

Never use materials other than specially produced softening salts in the salt container of your machine.

Never use materials other than specially produced detergents and rinse-aids in the detergent and rinse-aid containers of your machine.

When you want to change the position of your machine, follow all the warnings mentioned in this section after making sure that the machine is empty.

Please dispose of packaging material and old appliances carefully. Please ensure old machines do not become a threat to child safety. It is known that children lock themselves in unused machines. To avoid such a problem it is advised that you cut the mains cable off and break the door latch so it does not lock.

The door of your machine is designed to support the weight of a full basket when the lower basket is pulled all the way out. Never place any other load on the door, otherwise the machine may tip over.



## Warnings and Safety Information

### Environmental Protection

#### Recycling

This appliance's packaging material is recyclable. Help recycle it and protect the environment by dropping it off in the municipal receptacles provided for this purpose.



Your appliance also contains a great amount of recyclable material. It is marked with this label to indicate the used appliances that should not be mixed with other waste. This way, the appliance recycling organised by your manufacturer will be done under the best possible conditions, in compliance with European Directive 2002/96/EC on Waste Electrical and Electronic Equipment. Contact your town hall or your retailer for the used appliance collection points closest to your home. We thank you doing your part to protect the environment.

#### Energy and water saving

Remove the food remains (bones, pips, etc.) from dirty dishes. Start your dishwasher after fully loading the machine. Do not use the pre-wash program unless required. Make your program selection according to the dirt level given in the program selection chart on the daily usage card.

If you have a hot water inlet hose in your machine, you can use a ready hot water source (central hot water supply or hot water supply with solar energy) up to 60°C. You will save energy and help preserve natural resources. (please read the water inlet hose connection).

#### Unsuitable dishware

Do not wash items soiled with cigarette ash, candle, dyes, etc. since these may harm your machine

Do not wash forks, knives and spoons with wooden or bone handles, items stuck together with adhesives, plastic items not resistant to high temperature and copper and tin items in your dishwasher.

As with hand washing, some "on-glaze" decorated china, aluminum or silver have a tendency to discolor or fade. Also, certain types of glassware and crystals may lose their shine and become opaque in time.

Pay special attention to whether or not the dinnerware you wash in the dishwasher is dishwasher-proof.

Do not overload your dishwasher or do not load items other than those mentioned in this manual.



## Before first usage

After having opened the packing of your dishwasher, check the machine against any possible transportation damage. Never install and use damaged machines. If you're machine is damaged contact your seller or any authorized service immediately. Always have your machine installed by authorized service staff to ensure correct installation

Any repairs and maintenance work on this dishwasher should be carried out by authorized service staff only. Repairs conducted by third persons are not only dangerous, but also might lead to the cancellation of your warranty. The authorized service shall not be responsible for the renewal of your electricity and installation. Ensure your electricity and water connection are suitable for the machine before calling the authorized service engineer for installation.

Make sure the electricity and water connections of your dishwasher are in compliance with the instructions for assembly as stated in the relevant part of this manual

Any water remaining in the dishwasher after production is carefully removed due to reasons of hygiene.

Therefore, always select pre-wash or a programme with pre-wash before first time you use this appliance.

Before the first wash, add 1 lt of water in the salt container of your machine

If the hardness of the water you use is more than 60°dF (French Hardness) or if you are using pit water, we recommend that you use filters and purifiers.



## Connections

### Electricity



Information regarding the electrical specifications of your machine is provided on the sticker on the right side of the interior door.

If you have to make the connection of your machine to the mains voltage other than stated on the sticker, have a proper transformer connected.

If the fuse in your house is less than 16 Amperes, have a 16 Ampere-fuse connected by a qualified electrician.

Always call the authorized service whenever you want to change the mains cable of your machine.



## Connection

### Water Connection



#### Water inlet hose connection

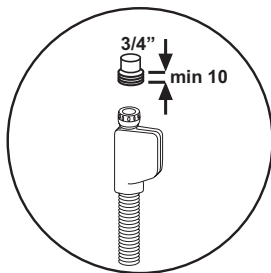
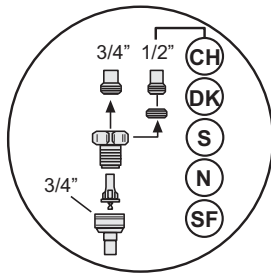
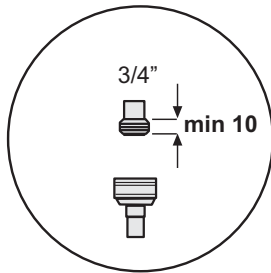

There are two different types of water inlet hoses:  
- Cold water inlet hose (up to 25°C)  
- Hot water inlet hose (up to 60°C)  
please check which one is applicable to your model.

If you are willing to connect your machine to natural energy resources or to the central hot water supply, first check out whether your water inlet hose type is suitable by checking the temperature values written on the hose. If your hose is not suitable, apply to your authorized service to change the hose.

The water inlet hose is directly connected to the tap. The water pressure coming from the tap must be minimum 0.3 and maximum 10 bars.

Please use a valve if the water pressure exceeds 10 bars. Please turn on the tap and check for leakages after connecting the hose. For safety reasons (if your machine does not have the watersafe feature.) Please ensure the tap is turned off when the machine is not used;

For models with **AQUABLOCK** ,

If the water connection is made properly, this system shall protect your house against floods.

The plastic frame of AQUABLOCK water intake system has electrical components. Never allow contact with water. Never cut the hose.

Appliance should be connected to the water mains with the new hose set. The hose set of the previous machine (if there is any) should be removed

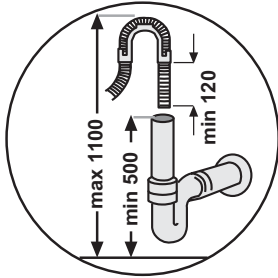

## Connections

### Drain hose connection

Fit the drainage hose of your machine to the drainage pipe without bending.

If the length of the hose is not sufficient, apply to the authorized service for an extension made from the same material as the original. Remember that the length of the hose should not exceed 4 meters even when with an extension. If the drainage hose is longer than 4 m. the dishes will not be cleaned properly. Secure your hose firmly to the drainage pipe to avoid it coming off during the washing process.



## Usage Information

### Water Softener

#### Water Hardness

The dishwasher requires lime free water. Hard water leaves water marks on your dinnerware. Your dishwasher has a special water softening system to remove the hardness of the water (Water softener).



## Usage Information

### Filling in the Water softener

Only use special pelletized dishwasher salt in your machine to soften the hard water. Never use other types of salts including table salt, animal feeding salt, sea salt, culinary salt. These types of salt do not dissolve in water easily and will damage your appliance beyond repair.

When you run the dishwasher, the Water softener will be full of water. Therefore, adding softening salt should always be done immediately before you start the dishwasher.

Every time you add salt in your dishwasher, always run the pre-wash program if you are not going to use the dishwasher immediately. This way, any excess salt solution will be immediately washed away.

You can put approximately 2 kg softening salt in the Water softener. When using salt tablest, do not fill container to the top. We recommend small grained or powder salt.

After salt is put in the machine for the first time, low salt indicator light (if applicable) will be off.

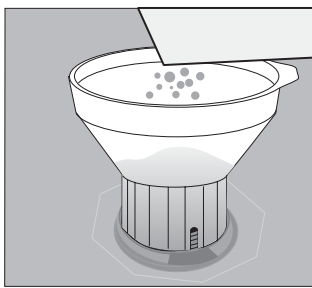
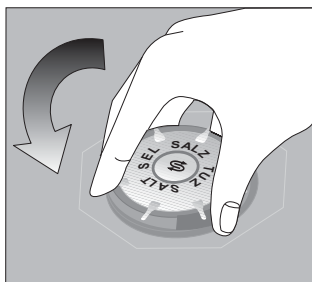



## Usage Information

### Detergent usage



#### Detergent

Use only detergent suitable for household dishwashers. Keep detergents in a cool and dry place and out of the reach of children.

Detergent must be added to the container before each use.

A detergent overdose may cause scratches your dishes and there may be traces of detergent left in your machine.

Detergents are classified into two groups: the ones containing phosphate and the ones not containing phosphate. You can use both types of detergents.

#### Eco/Bio Programs and Enzyme Based Detergents

Unlike traditional detergents, new detergents contain natural enzymes rather than the caustic chemicals. Enzyme based detergents can be decomposed biologically. Furthermore, their ability to clean is more effective in lower temperatures than traditional detergents.



You can maintain the wash performance of the normal detergent in 65°C, by using the proper Eco/Bio program with the enzyme based detergent in 50-55°C. If your dishwasher has the Eco/Bio program, use enzyme based detergents.

#### Warning!

"Two-in-One", "Three-in-One" Detergents

Detergents that are marketed as "Two-in-One", "Three-in-One", generally, do not produce the best possible results. They may be effective under certain conditions. You may be able to find out about these conditions by contacting the manufacturer of these detergents. These detergents contain pre-determined amounts of detergent, softening salt and/or rinse aid and therefore can not be adjusted to best suit the requirements of the dishes being washed and the water supply available in your home.

If you experience problems after using such detergents, contact the manufacturer of detergent for assistance. The guarantee does not cover damages as a result of these detergents.

Your dishwasher is equipped with adjustable rinse aid dosage, adjustable water softening salt dosage and you can put the correct amount of detergent required in to the detergent dispenser. By this way, best possible results can be achieved.

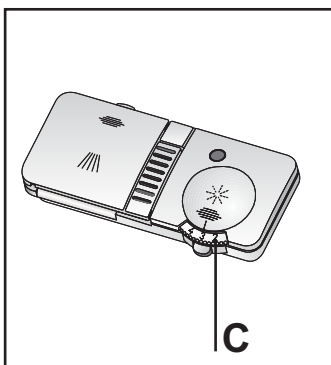
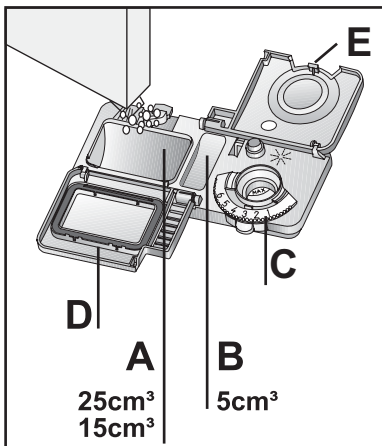

## Usage Information

### Pouring the detergent

If the dishwasher is considerably full and the dishes are relatively dirty, fill the main container (A) up to 25cm<sup>3</sup> level. If the dishwasher is not quite full and the dishes are only slightly soiled, fill the main container (A) only up to 15cm<sup>3</sup> level.

If your dishes are kept unwashed for a long time and the food particles are stuck on the dishes also fill the small container (B) up to 5cm<sup>3</sup>.

of soiling and the water hardness in your area it may be necessary to add more detergent.

detergents are poured into the dispenser. If you are using tablet detergent read the manufacturer's recommendations on the packaging in order to determine where the tablets should be placed inside the dishwasher (detergent dispenser, cutlery basket, etc.) put in the detergent, shut the container lid (D) and ensure you hear the clicking sound.

During the wash programme the detergent will dispense automatically and the lid (D) will remain open when the programme finishes.

Do not use detergent when using the pre-wash programme.

### Rinse-aid usage



#### Rinse aid

Use only rinse aid intended for household dishwashers.

The rinse aid is specially formulated to be used in the dishwashers for the prevention of watermarks and scale on dishes and to increase the efficiency of the washing and drying processes. Therefore, make sure that there is adequate amount of rinse aid in the rinse aid dispenser of your machine.

You can adjust the amount of rinse aid used during the wash programme by turning the rinse aid dispenser regulator (C).

The dispenser regulator (C) may be set between levels 1 and 6 (6 being the maximum amount of rinse aid usage). Your machine is pre-set at the factory to level 4.

According to the finish and drying results obtained, adjust the dose of rinse aid by means of the six position selector. (Position 1: minimum dose, Position 6: maximum dose.) Gradually increase the dose if there are drops of water or lime spots on the dishes after washing. Reduce it if there are sticky whitish streaks on the dishes.



## Usage Information

### Filling the rinse aid dispenser

Open the rinse aid container lid.

Fill up with rinse aid until the container is full to level of 'max' mark .

Put the lid (E) on and ensure you hear the clicking sound.

Remember to **CLOSE** the lid after every refill.

Make sure you clean any rinse aid that you might have spilled.

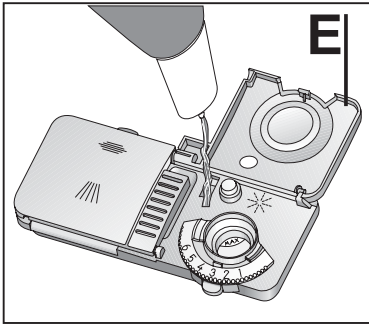
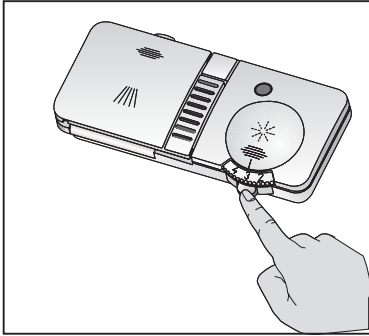

### Visual indicator

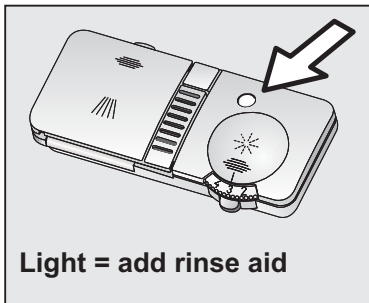
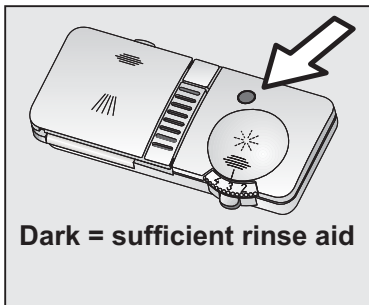



## **Operating the dishwasher**

### **Loading dishwasher**

Loading the dishwasher correctly will increase the washing, drying and energy performance of your machine. Examine the information given in this section and the information stated in the daily usage card given with the manual.

Place large or heavily soiled items in the lower basket, and small, light or delicate articles in the upper basket. Put forks, knives and spoons in the cutlery basket.

Place tall, narrow items in the middle of the racks.

Long-stemmed glasses should lean against the basket, the racks, or the supports (if applicable), not against the dishware.

When loading your dishwasher please ensure tall glasses (and/or wine glasses) rest against the sides of the upper basket or the glass holders. Do not allow tall glasses to rest against each other since they may be damaged during washing if not properly supported.

### **Unloading dishwasher**

Dishes should be allowed to cool for about 15 minutes after the end of the program.

Dishes will cool quicker, if the door is left open slightly.

Caution: Beware of hot steam if you open the door immediately after the program ends.

First unload the lower, then the upper rack. This prevents drops of water from falling onto the full lower basket when the dishes in the upper basket are being removed.



## Cleaning And Upkeep Of Your Appliance

To keep your appliance in good working order, we recommend that you use **Clearit** household products.



*Professional expertise for  
the general public*

**Clearit** offers you professional products and adapted solutions for the daily upkeep of your household and kitchen appliances.

You may find them in conventional retail outlets, along with a complete line of by-products and consumables. Cleaning your machine at regular intervals ensures longer product life and reduces the risk of recurring problems.

Always unplug the appliance and shut the water connection valve before cleaning.

Wipe the control panel with a soft damp cloth.

Do not use corrosive substances.

Wipe clean the door gasket with a damp cloth

## How to clean the filters

For the efficient operation of your dishwasher, check the filters and the spray arms before each wash.

There are three different filters in your machine

Main filter  
Coarse filter  
Micro filter

To clean the filters:

Remove the coarse filter by turning it anti clockwise.

Remove the micro filter from the coarse filter by releasing the latches.

Pull the main filter off.

Clean all three filters under running tap water with a brush.

Reinsert the main filter in its place.

Place the micro filter into the coarse filter. Ensure the marks align properly.

Turn the main filter clockwise until you hear a clicking sound.

For a better wash performance it is important that you fit the filters correctly.

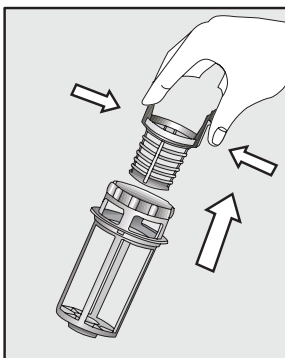
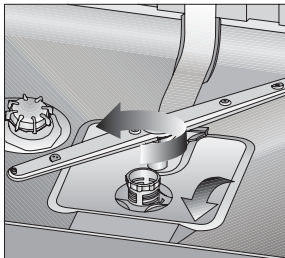

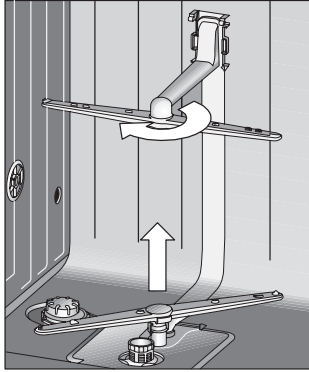

## How to clean up your machine

### How to clean the spray arms

#### Upper spray arm:

Turn the nut anti-clockwise and remove both the nut and the spray arm.

Flush away food particles under running water. Put the spray arm back on and screw on the nut turning clockwise until a clicking sound is heard.

#### Lower spray arm:

Remove the spray arm from its slot by releasing the latches and pulling it upwards.

Flush away the food particles under running water. Reinsert the spray arm back into its original position



## How to change the place of your dishwasher

Empty your machine and shut the water intake valve.

Disconnect the water inlet and drainage hoses.

Disconnect all other hoses/cables that may prevent the movement of your machine.

Make sure the hoses do not get tangled during carriage.

Please keep the machine upright or laying on its back during carriage to prevent water getting into the control panel. Getting water into the control panel may cause product failure.



## Troubleshooting

Before calling your nearest service centre check the following:



Is the machine connected to the mains supply



Is the fuse in the mains plug has not blown.



Is the water tap fully turned on?



Is the machine switched on?



Is the dishwasher door closed firmly?



Are the filters clogged?



Is the detergent dosage and/or rinse aid sufficient? Is there enough salt in the water softener?



## EC declaration of conformity

This appliance has been designed, constructed and distributed in compliance with the safety requirements of EC directives. Load capacity : 10 place settings.

### After Sales Service:

Any maintenance on your equipment should be undertaken by:

- either your dealer,
- or another qualified mechanic who is an authorized agent for the brand appliances.

When making an appointment, state the full reference of your equipment (model, type and serial number). This information appears on the manufacturer's nameplate attached to your equipment.

**73/23/EC**  
**89/336/EC**  
**93/68/EC**  
**IEC 436/DIN 44990**  
**EN 50242**



## How to cancel the washing programme

To cancel a programme while the machine is operating:

Press start/stop button. The indicator light will go off.

Press start/stop button for 5 seconds again. The indicator light will start flashing. Close the door. The machine will drain the water inside the machine for 45 seconds. The programme is cancelled when start/stop indicator light goes off. Then, you can choose and start a new programme.

**! Important:** Depending on the stage of the programme you have cancelled, there may be detergent residue or rinse aid inside the machine and on the load. Make sure the items in the dishwasher are not used before washing properly.

## How to change the washing programme

To change the programme selection while the machine is operating open the door.

Press start/stop button. The indicator light will go off.

Select the new programme. Press start/stop button. The indicator light will be on and close the door new programme will start.

**! Important:** The new programme will NOT start right from the beginning. It will start from the stage last carried out by the previous programme selection.

Programme symbols and temperatures	1	2	3	4 **	5	6	7	8
	<b>Prewash</b>	<b>30 min. 35°C</b>	<b>Delicate 40°C</b>	<b>Eco 50°C</b>	<b>Normal 55°C</b>	<b>Intensive 70°C</b>	<b>Boost 70°C</b>	<b>Auto 55°C-65°C</b>
	For rinsing dishes that will not be washed immediately	Glasses, lightly soiled dishes and short programme	Glasses, lightly soiled dishes	Soiled dishes that have been kept in the machine	Soiled dishes	Heavily soiled dishes that have been kept in the machine OR Heavily soiled dishes requiring pre-wash.	Heavily soiled dishes that have been kept in the machine OR Heavily soiled dishes requiring pre-wash.	Automatically senses water dirtiness level and washes until dishes are completely cleaned.
<b>Detergent compartment</b> A=25 cm <sup>3</sup> / 15 cm <sup>3</sup> B=5 cm <sup>3</sup>	-	A	A	A+B	A+B	A+B	A+B	A
<b>programme sequence</b>	Pre-wash ↓ End	35°C wash ↓ Cold rinse ↓ Clear rinse ↓ Dry ↓ End	Pre-wash ↓ 40° wash ↓ Cold rinse ↓ Clear rinse ↓ Dry ↓ End	Pre-wash ↓ 50° wash ↓ Cold rinse ↓ Clear rinse ↓ Dry ↓ End	Pre-wash ↓ 55° wash ↓ Cold rinse ↓ Clear rinse ↓ Dry ↓ End	50°C Pre-wash ↓ 70° wash ↓ Cold rinse ↓ Clear rinse ↓ Dry ↓ End	50°C Pre-wash ↓ 70° wash ↓ Cold rinse ↓ Clear rinse ↓ Dry ↓ End	Programme sequence is adjusted automatically according to the dirtiness of the dishes.
<b>Consumption figures</b>								
<b>Water (Liter)</b>	3,4	9,6	12,4	12	12,4	17,2	15,4	9,6 - 18,4
<b>Energy (kWh)</b>	-	0,75	0,80	1,01	1,00	1,40	1,67	1,00 - 1,25
<b>Duration (min)</b>	15	30	71	170	96	128	124	112-130

\* Values declared on the product or in the operating instruction booklet / programme chart and quick reference card supplied with the product are obtained in tests performed under controlled laboratory conditions and these tests are as defined in relevant standards

\*\* Reference programme for the Testing Institute and energy labeling.  
Testing program: Eco 50°C as compliant to EN 50242 international norms.



On / Off button

## Operating the dishwasher

- Turn the tap on. Open the door of the machine.
- Check that the upper and lower spray arms can rotate freely. Pour (Put in) the detergent.
- Push in the on/off button and check that the display lights comes on. Check the salt and rinse aid level indicators before you start the machine. If necessary add salt and rinse aid.
- Select the required programme by referring to the programme chart. By pressing the appropriate programme selection button, the programme is selected and the indicator light of the programme comes on. Then select from available options, if required.
- Press start / stop button and check that the function indicator light comes on.
- Close the door then programme starts.
- In case the door is opened while the machine is working, then a safety mechanism ensures the machine immediately stops. Water may be very hot, so be careful.
- ! Care must be taken if opening the door, as steam and water will escape.
- An audio signal with an interval of 10 seconds warns you to switch your machine off when the selected washing program ends. This audio signal warns you for a duration of 5 minutes and then turns off.
- Open the door Press the on/off button after the programme is completed. The indicator lights will go off.
- Turn of the water tap, unload the baskets.

## Options

### Half Load (½)

Select Half Load when using any wash programme [Except Pre-wash] to save on water, electricity and time if the machine is only half full. You can place dishes anywhere in the machine; some upper and some lower basket.

### Display

Water hardness level and Time Delay for the selected programme are displayed.

### Time Delay

This option enables you to start the selected programme with a delay of 1 – 24 hours. Time Delay is adjusted by pressing plus delay button near the display. After adjusting the required Time Delay, press Start / Stop button and close the door. At the end of the delay set, the programme starts automatically.

During a programme, Time Delay option does not function.

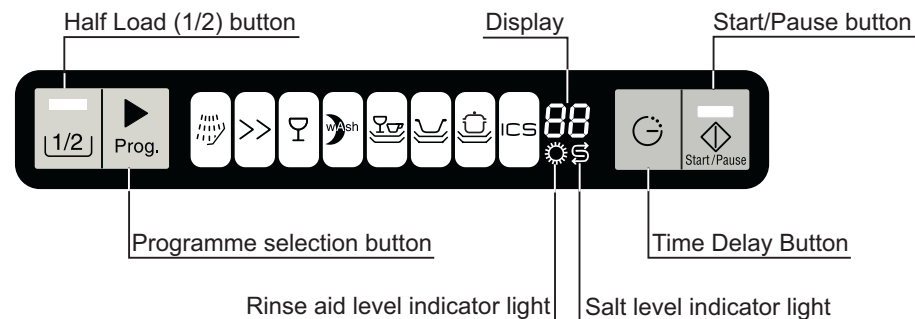

Half Load (1/2) button

Display

Start/Pause button

Programme selection button

Time Delay Button

Rinse aid level indicator light

Salt level indicator light

### Loading the dishwasher

There are three separate baskets, in which you can put your dinnerware, in your machine. The shelves on the rack are made adjustable to accommodate tall pieces.

### Folding Plate Support Rods (if applicable)

There are four separate "folding plate support rods" in the lower basket of your dishwasher designed to allow you more space to accommodate saucepans and large bowls in the lower basket. You can either fold each section (A, B, C, D) individually or, all at once, to create a large empty space. Hold the rods and gently lift 1. Then simply bring forward 2 and fold them down.

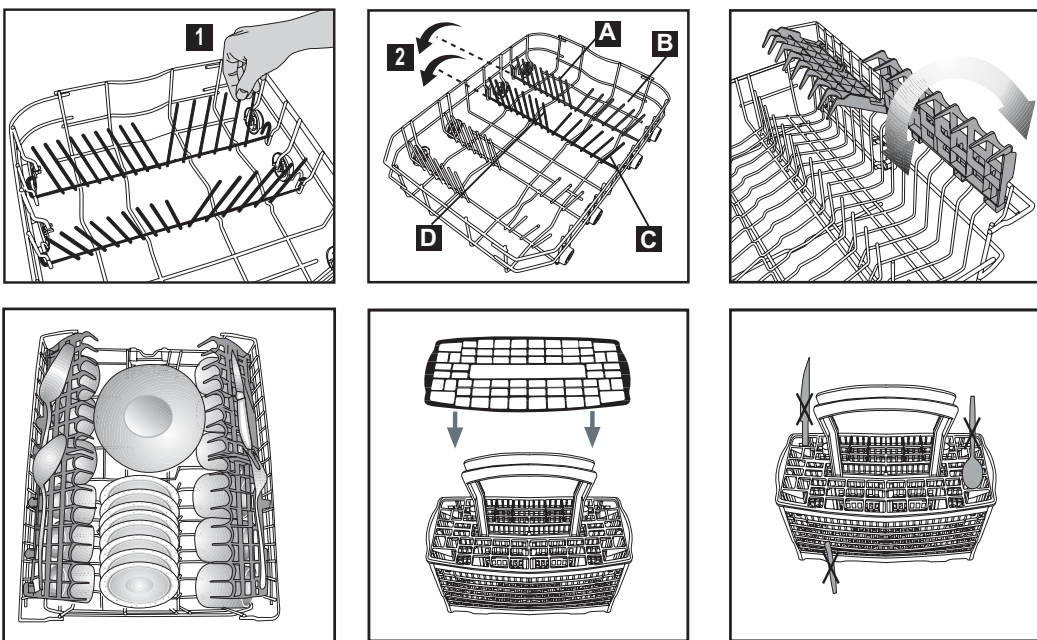

Long cutlery, such as ladles and long knives, etc must be placed horizontally on top of the full cutlery basket or on the racks to prevent accidental injury. Place spoons and forks in the cutlery basket with handles down and knives with handles up to prevent accidental injury.

### Upper Basket Height Adjustment

The default position of the upper basket of your machine is adjusted at the higher position. According to the size of the dishes you can change the position of the upper basket. To do this, Release the latches on both the right and left tracks by turning them sideways. Remove the basket.

Change the position of the rollers and place the basket back on the track then shut the latches.

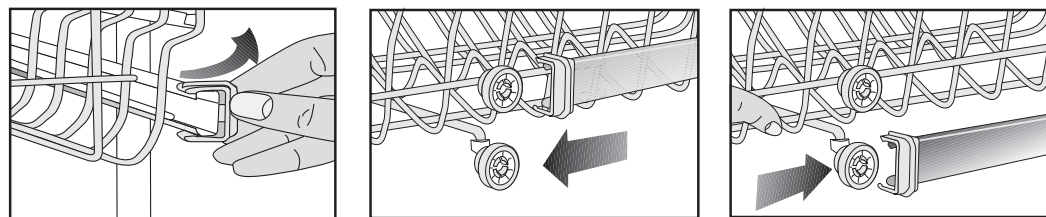

### Note for Testing Institutes

The necessary information for performance testing will be provided upon request. The request can be done by e-mail through: [dishwasher@standardloading.com](mailto:dishwasher@standardloading.com)

Please do not forget to write the model code and stock code information of the appliance besides your contact information in the e-mail. The model code and stock code information can be found on the rating label, which is placed on the side of the door.